

## Features

- 400W Peak Pulse Power Per Line(8/20us)
- 8V Working Peak Reverse Voltage
- Maximum Reverse Peak Pulse Current:20A
- ESD per IEC 61000-4-2(Contact):30KV
- ESD per IEC 61000-4-2(Air):30KV
- Clamping Voltage @IPP=1A:10.2V
- Junction Capacitance:0.6PF
- Package:SOD-323(0805)
- Polarity: Bidirectional

## Mechanical Characteristics

- Mechanical Characteristics
- Lead Finish: NiPdAu
- Case Material: “ Green ” Molding Compound.
- UL Flammability Classification Rating 94V-0
- Moisture Sensitivity: Level 3 per J-STD-020
- Terminal Connections: See Diagram Below
- Marking Information: See Below

## Schematic And Configuration

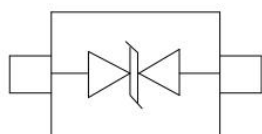

## Ordering Information

Part Number	Packaging	Reel Size
TEVD0R6V08B1X	Tape & Reel	7inch

## Absolute Maximum Ratings (Ta=25°C, RH=45%-75%, unless otherwise noted)

Parameter	Symbol	Value	Unit
Operating Temperature Range	Tj	-55~+125	
Storage Temperature Range	Tstg	-55~+150	

## Electrical Characteristics (Ta=25°C)

Parameter	Symbol	Min	Type	Max	Unit	Test Condition
Reverse Working Voltage	Vrwm			8	V	
Breakdown Voltage	Vbr	9.2			V	It=1mA
Reverse Leakage Current	Ir			0.1	uA	Vrwm=8V
Clamping Voltage	Vc		10.2	11.6	V	Ipp=1A(8 × 20us pulse)
Juntion Capacitance	Cj		0.6	0.8	pF	Vr=0V,f=1MHz

Typical Performance Characteristics (Ta=25 , unless otherwise noted)

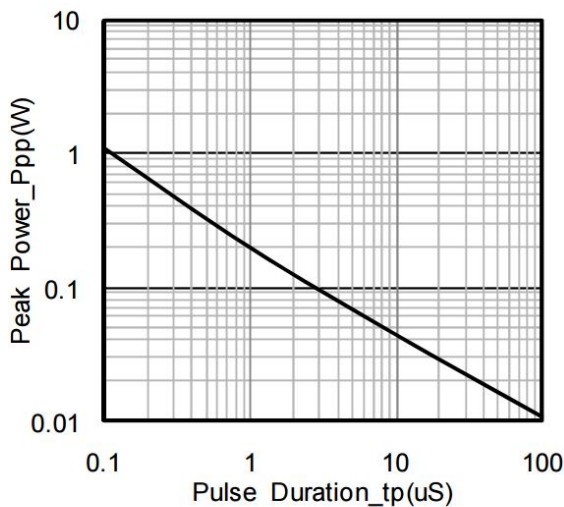

Peak Pulse Power vs. Pulse Time

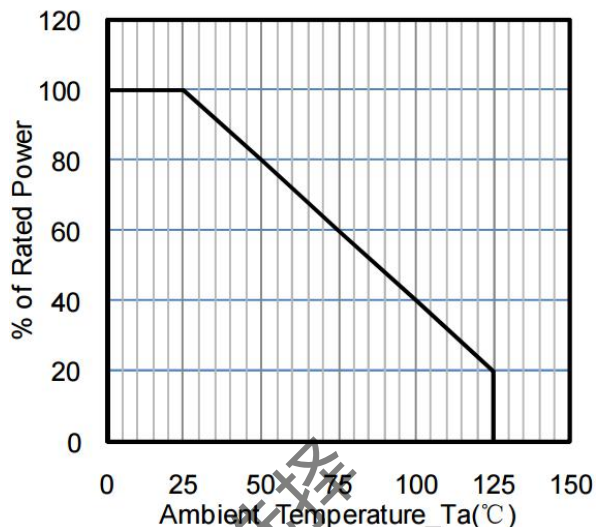

Power Derating Curve

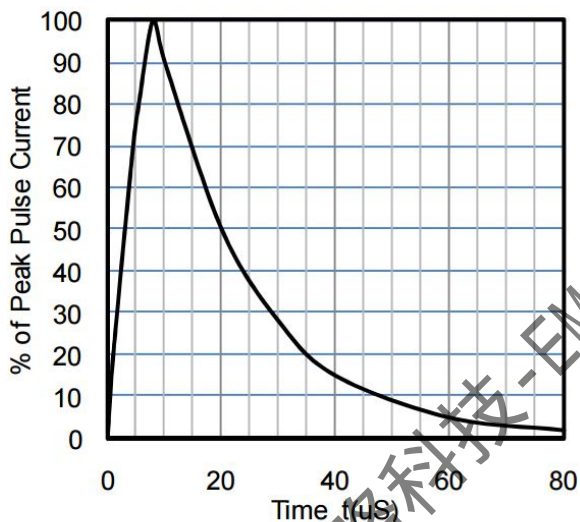

8 X 20uS Pulse Waveform

超略科技-EMC方案的最佳选择

Soldering Parameters

Reflow Condition		Pb-Free Assembly (see as bellow)
Pre Heat	-Temperature Min ( $T_{s(min)}$ )	+150°C
	-Temperature Max( $T_{s(max)}$ )	+200°C
	-Time (Min to Max) (ts)	60-180 secs.
Average ramp up rate (Liquid us Temp ( $T_L$ ) to peak)		3°C/sec. Max
$T_{s(max)}$ to $T_L$ - Ramp-up Rate		3°C/sec. Max
Reflow	-Temperature( $T_L$ ) (Liquid us)	+217°C
	-Temperature( $t_L$ )	60-150 secs.
Peak Temp ( $T_P$ )		+260(+0/-5)°C
Time within 5°C of actual Peak Temp ( $t_p$ )		30 secs. Max
Ramp-down Rate		6°C/sec. Max
Time 25°C to Peak Temp ( $T_P$ )		8 min. Max
Do not exceed		+260°C

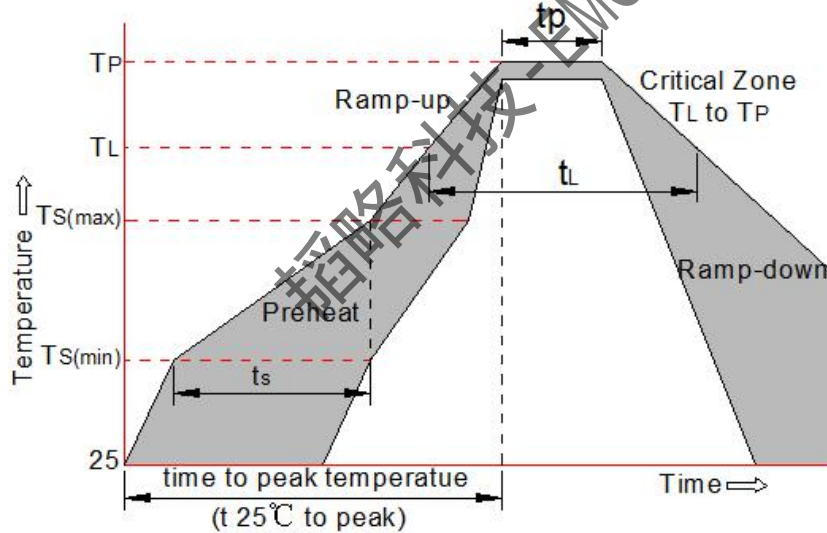

Package Mechanical Data

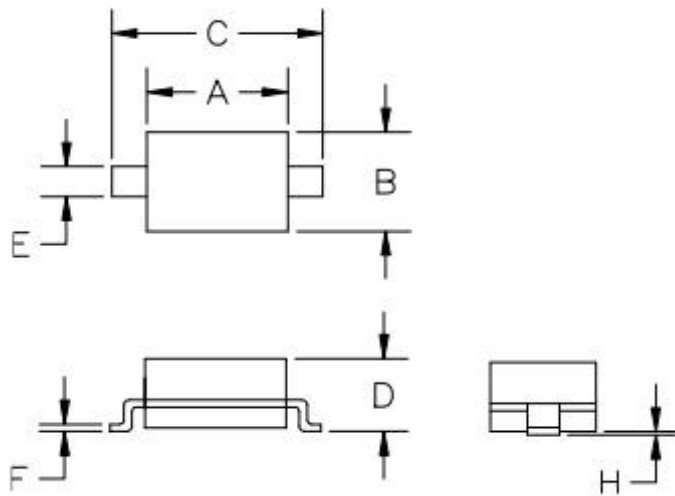

SYM	DIMENSIONS			
	MILLIMETERS		INCHES	
	MIN	MAX	MIN	MAX
A	1.50	1.80	0.060	0.071
B	1.20	1.40	0.045	0.054
C	2.30	2.70	0.090	0.107
D	-	1.10	-	0.043
E	0.30	0.40	0.012	0.016
F	0.10	0.25	0.004	0.010
H	-	0.10	-	0.004

Suggested Land Pattern

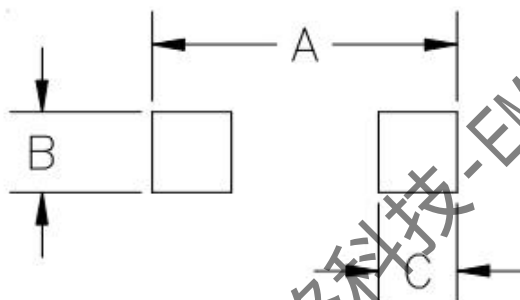

SYM	DIMENSIONS	
	MILLIMETERS	INCHES
A	3.15	0.120
B	0.80	0.031
C	0.80	0.031

Contact Information

SHENZHEN TOP-FLIGHT TECHNOLOGY CO.,LTD

4th Floor, C Building, Quansen Industrial Park , Bulong Road, Longhua New District, Shenzhen

Tel: 86-755-82908191 Fax: 86-755-82908701 Email: kang@topleve.com

Website: <http://www.topleve.com>